



High speed precision spindles

SCHEDA TECNICA

TMPE 2 L/A ER20



MODELLO	TENSIONE [Volt]	FREQUENZA [Hz]	GIRI	POT. RESA [Kw]	ASSORB. [Amp]	Cos j	PESO [Kg]
TMPE2 9/2 RR aria compressa	220/380	50	3000	0,10	0,85/0,50	0,60	4,0
9/2 RR liquido	220/380	50	3000	0,12	1,00/0,60	0,60	4,0
TMPE2 9/2 RR aria compressa	220/380	100	6000	0,22	1,47/0,85	0,65	4,0
9/2 RR liquido	220/380	100	6000	0,25	1,66/1,96	0,65	4,0
TMPE2 9/2 RR aria compressa	220/380	200	12000	0,55	2,60/1,50	0,73	4,0
9/2 RR liquido	220/380	200	12000	0,60	2,80/1,60	0,73	4,0
TMPE2 9/2 RR aria compressa	220/380	300	18000	0,75	3,70/2,15	0,71	4,0
9/2 RR liquido	220/380	300	18000	0,80	3,80/2,20	0,71	4,0
TMPE2 9/2 RR aria compressa	220/380	400	24000	0,80	4,10/2,40	0,71	4,0
9/2 RR liquido	220/380	400	24000	0,85	4,50/2,60	0,71	4,0

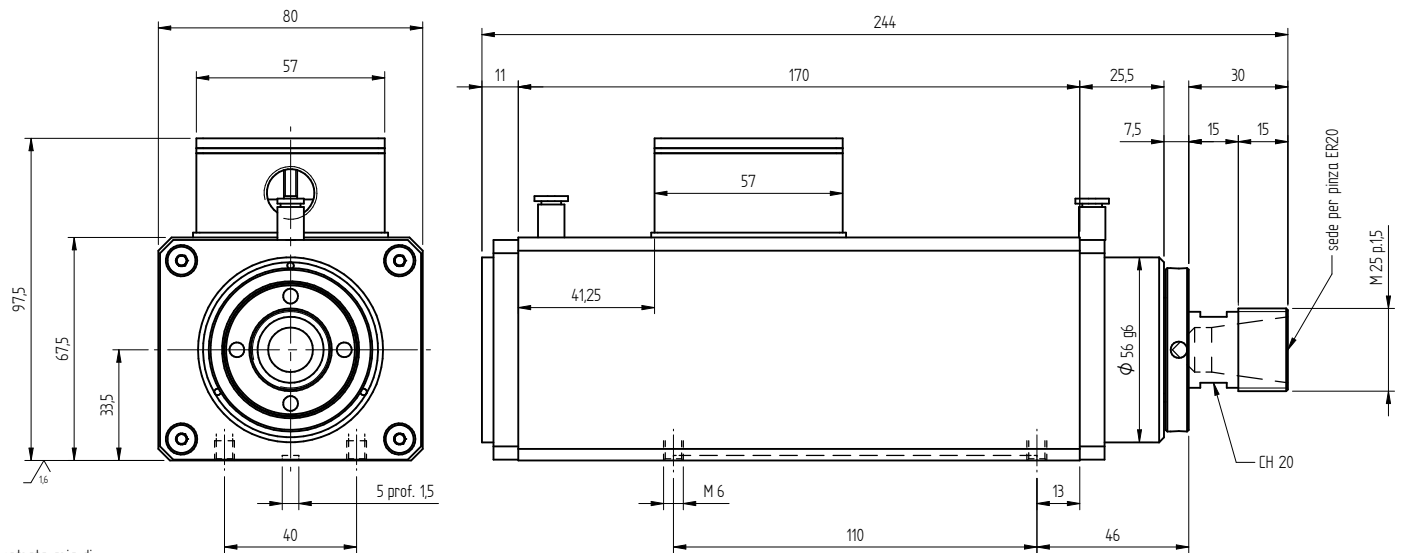

entrata aria di raffreddamento 6 bar

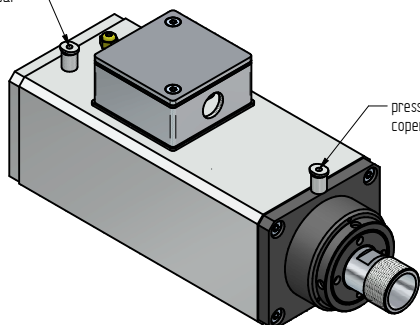

pressurizzazione coperchio 2/3 bar

